

State Line

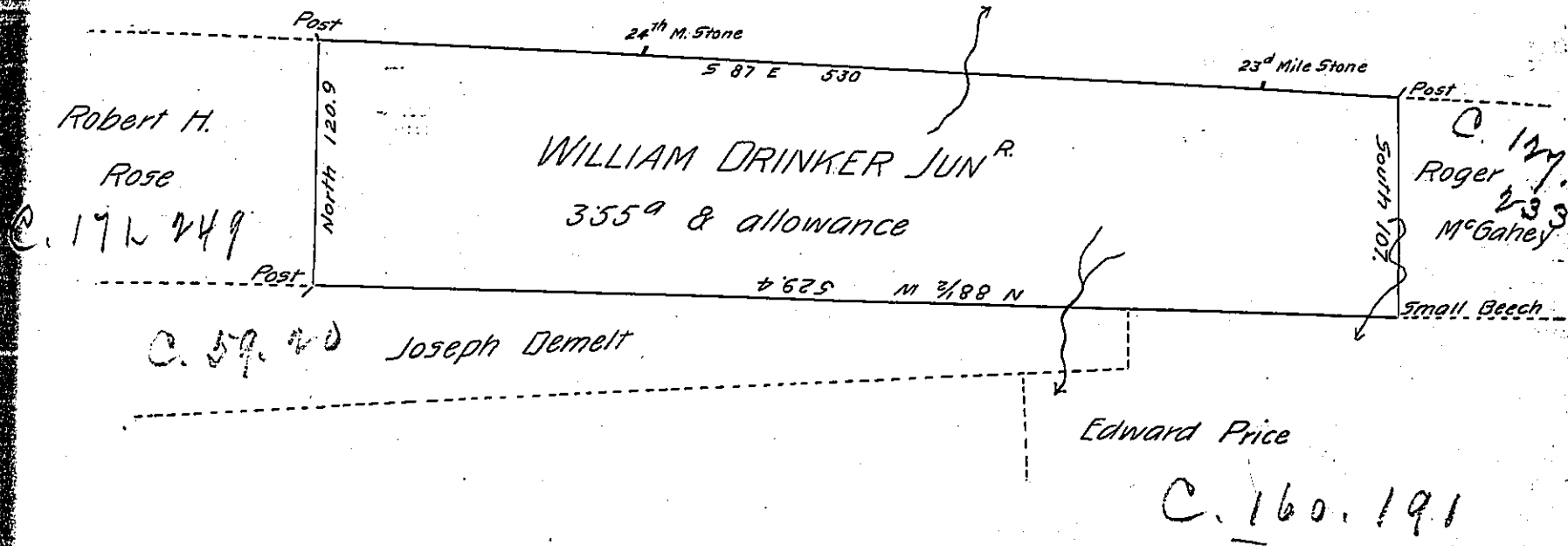

A draught of a tract of unimproved land containing three hundred and fifty five acres and allowance of six per cent for roads situate adjoining the state line in the Township of Lawsville Susquehanna County Surveyed the 21<sup>st</sup> day of October 1816 to William Drinker Junr In pursuance of a Warrant dated the 3<sup>d</sup> day of September 1816

Jonathan Stevens D.S.

Rich<sup>d</sup> T Leech Esq<sup>r</sup> S. Gen<sup>l</sup>

IN TESTIMONY that the above is a copy of the original remaining on file in the Department of Internal Affairs of Pennsylvania, made conformably to an Act of Assembly approved the 16th day of February, 1833, I have hereunto set my Hand and caused the Seal of said Department to be affixed at Harrisburg, this first day of August 1904

*James R. Brown*  
Secretary of Internal Affairs.